





Ground Floor

Entrance Hallway

Enter the property via a composite/partly double glazed front door and having a coved ceiling with a ceiling light point, a central heating radiator, Karndean flooring, a carpeted spindle stairway leading to the first floor, access to the dining kitchen and solid wood cottage style doors opening to the lounge and the downstairs WC.

Lounge

14' 2" x 10' 7" (4.33m x 3.23m)

Having a uPVC/double glazed walk-in bay window to the front aspect fitted with venetian blinds, a ceiling light point, a coved ceiling, a central heating radiator and Karndean flooring.

Dining Kitchen with Breakfast Area

8' 10" x 23' 9" (2.69m x 7.23m)

Being fitted with a range of gloss-finished handle-less wall, base and drawer units with laminate worksurface over and having two uPVC/double glazed windows to the rear aspect both fitted with venetian blinds, ceiling spotlight with the addition of two ceiling light points over the breakfast bar, a partly coved ceiling, two central heating radiators, a one bowl sink with a mixer spray tap fitted and a drainer unit, tiled splashbacks, a wall unit housing the boiler, an electric oven integrated in a tall cabinet with an integrated microwave above, a five-burner gas hob with an integrated extraction unit over, Karndean flooring, an integrated, upright fridge/freezer, both an integrated dishwasher and washing machine, both plinth lighting and under cupboard accent lighting, a solid wood cottage style door opening to the reception room/bedroom five, solid wood and partly glazed French doors opening to the lounge and uPVC/double glazed French doors to the rear aspect opening to the garden.

Reception Room/Bedroom Five

16' 6" x 7' 11" (5.03m x 2.41m)

Having a uPVC/double glazed window to the front aspect fitted with venetian blinds, a ceiling light point, a central heating radiator and laminate flooring.

Downstairs WC

Having a ceiling light point, a central heating radiator, a WC, a wash hand basin with a mixer tap fitted, an extraction unit and Karndean flooring.



First Floor

Landing

Having a ceiling light point, carpeted flooring, access to the loft space, an airing cupboard and doors opening to four bedrooms and the family bathroom.

Bedroom One

13' 5" x 11' 3" (4.09m x 3.43m)

Having a uPVC/double glazed window to the front aspect fitted with venetian blinds, a ceiling light point with a fan, a central heating radiator, carpeted flooring, built-in wardrobes and a door opening to the en-suite shower room.

En-suite Shower Room

Having an obscured uPVC/double glazed window to the side aspect, a ceiling light point, a central heating radiator, tiled flooring, a shaver point, an extraction unit, a WC, a wash hand basin with a mixer tap fitted, partly tiled walls and a shower cubicle with a thermostatic shower installed.

Bedroom Two

12' 1" x 12' 4" max (3.68m x 3.76m max)

Having two uPVC/double glazed windows to the front aspect, a ceiling light point, a central heating radiator, carpeted flooring and built-in wardrobes.

Bedroom Three

9' 11" x 9' 3" (3.02m x 2.82m)

Having a uPVC/double glazed window to the rear aspect, a ceiling light point, a central heating radiator and carpeted flooring.

Bedroom Four

6' 11" x 8' 11" (2.11m x 2.72m)

Having a uPVC/double glazed window to the rear aspect, a ceiling light point, a central heating radiator and carpeted flooring.

Family Bathroom

Having an obscured uPVC/double glazed window to the rear aspect, a ceiling light point, a chrome-finished central heating towel rail, a WC, a wash hand basin with a mixer tap fitted, a shaver point, partly tiled walls, tiled flooring, an extraction unit and a bath with an electric power shower over.

Outside

Front

Having a tarmac driveway suitable for multiple cars as well as an additional gravel area which could be used for extra parking. There is also a privacy hedge to the border and access to the rear garden via a wooden side gate.

Rear

Being mainly lawn with a decked area and a patio seating area, a large wooden shed, an outdoor double electrical socket, outdoor accent lighting and security lighting, an outside cold water tap and access to the front via a wooden side gate.









* Immaculately presented and located on a very desirable estate *

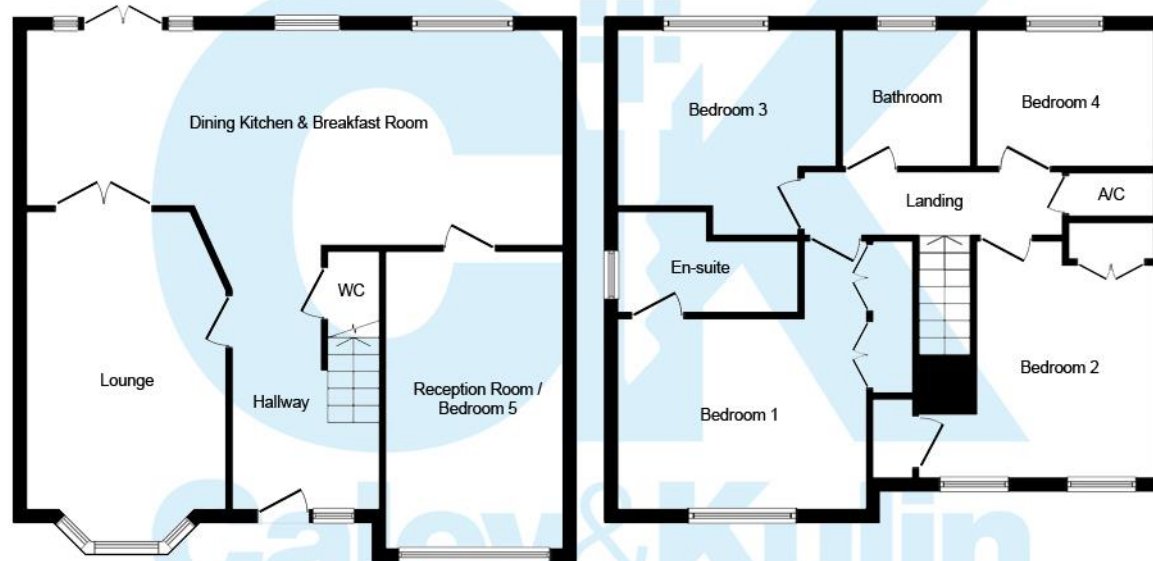

Please note; this floorplan is for illustration purposes only and may not be a true reflection of the property's layout nor is this plan drawn to scale.

To view this property please contact Caley & Kulin on:

Cannock: 01543 396880 **Stafford:** 01785 559880

Wolverhampton: 01902 953923

E-mail: info@candk.co.uk

Staffordshire House, Clay Street, Penkridge, Stafford, ST19 5AF

View this property online candk.co.uk

EPC Rating: C

Tenure: Freehold

Council Tax Band: D

Version: CK1180/001



Find us on facebook

facebook.com/candk.co.uk



These particulars are not to form part of a Sale Contract owing to the possibility of errors and/or omissions. Prospective purchasers should therefore satisfy themselves by inspection or otherwise as to their correctness. All fixtures, fittings, chattels and other items not mentioned are specifically excluded unless otherwise agreed within the Sale Contract documentaries or left in situ and gratis upon completion. The property is also sold subject to rights of way, public footpaths, easements, wayleaves, covenants and any other matters which may affect the legal title. The Agent has not formally verified the property's structural integrity, ownership, tenure, acreages, estimated square footage, planning/building regulations status or the availability/operation of services and/or appliances. Therefore prospective purchasers are advised to seek validation of all the above matters prior to expressing any formal intent to purchase.

See all our properties at www.candk.co.uk | www.rightmove.co.uk

